

## 1561 SERIES

■ Wire to Board System  
pitch 5.0mm(.197")

■ Specifications

1. Current rating: 5A AC/DC
2. Voltage rating: 250V AC/DC
3. Withstand voltage: 1000V AC/minute
4. Insulation resistance: 1000M ohm min
5. Contact resistance: 20m ohm max
6. Temperature range: -25°C to +85°C

7. Applicable PC board thickness:

1.0~1.6mm(.039" to .063")

8. Applicable wires: AWG#24 #18

Insulation O.D.: 1.3~2.4mm

9. Circuits: 1~6 circuits available

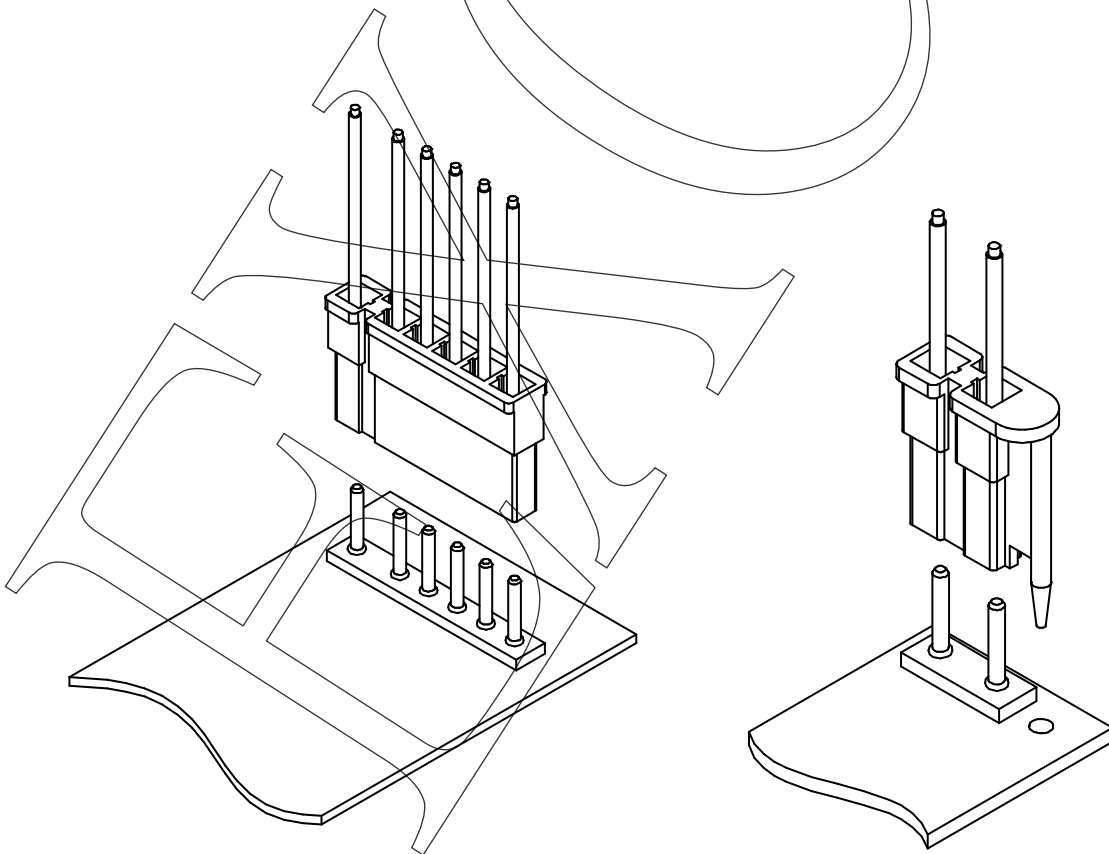

## 1561 SERIES

### Crimp Terminal

1. Part No.: 156100TC051
2. Part Name: 1561 Terminal
3. Material: Phosphor, Brass bronze
4. Finishing: Tin-plated

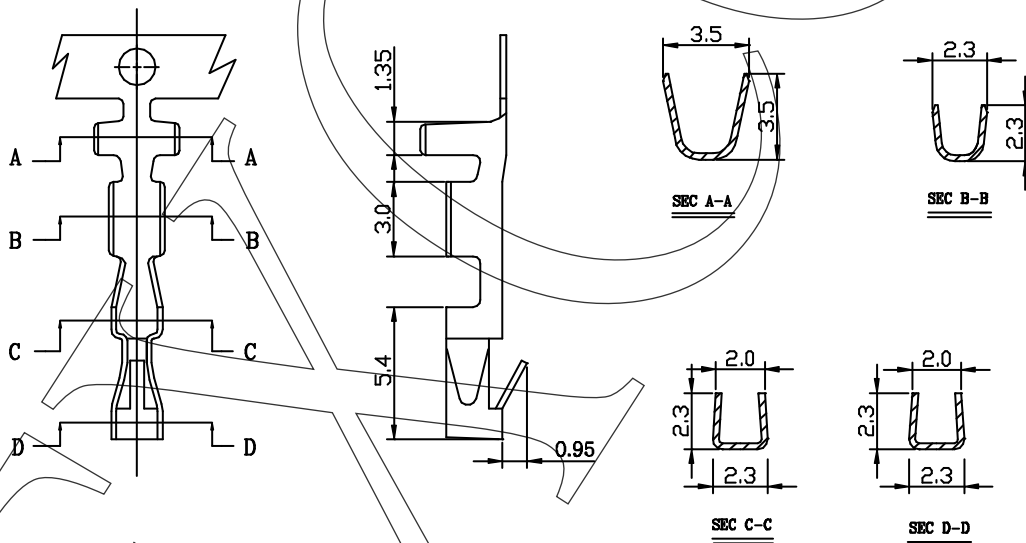
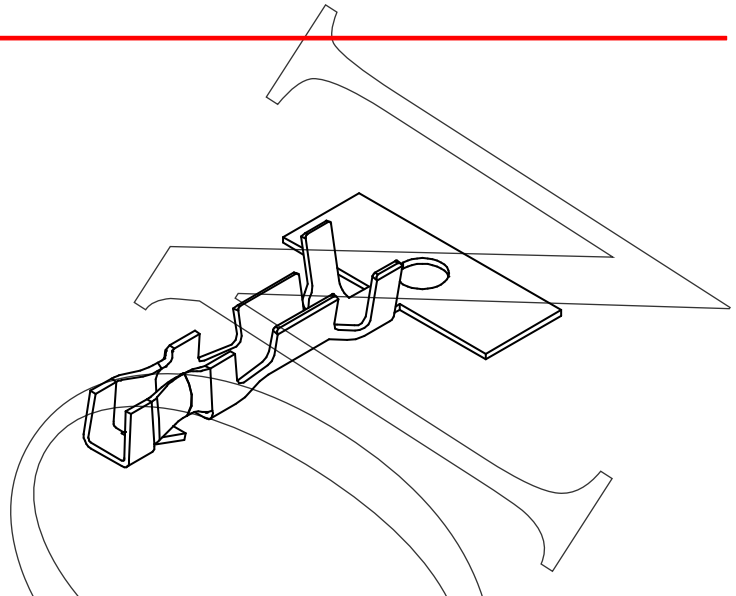

### Ordering Information and Dimensions:

Part No.	Wire Range	Insulation O.D.	Material	Finishing	Q'ty/reel
156100TC051	AWG#26~#20	1.3~2.4mm	Brass	Tin-plated	6,000pcs
156100TC351	AWG#26~#20	1.3~2.4mm	Phosphor	Tin-plated	6,000pcs

## 1561 SERIES

### Housing

1. Part No.: 1561xxHA001
2. Part Name: 1561 Housing
3. Material: Nylon 66 UL 94V0
4. Color: Natural

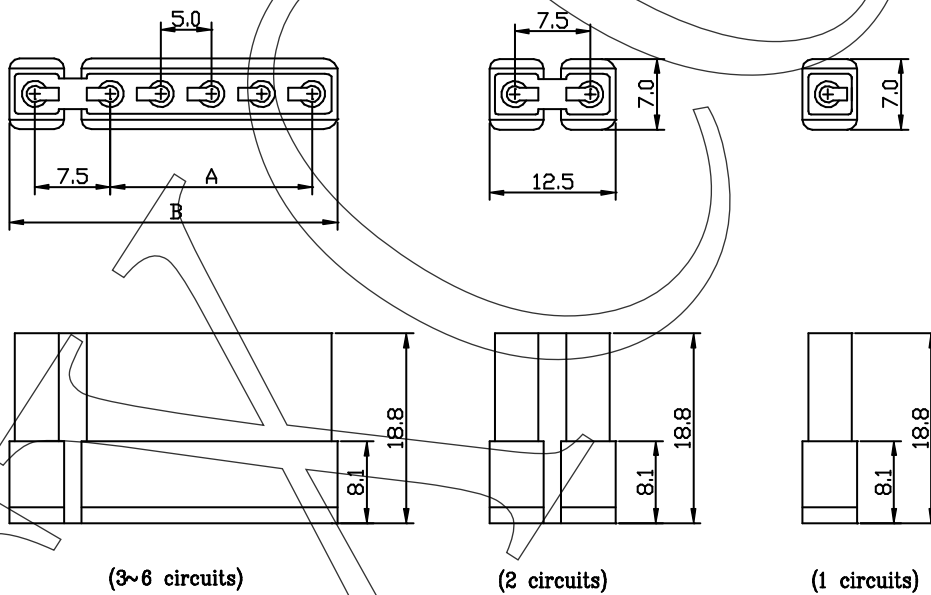
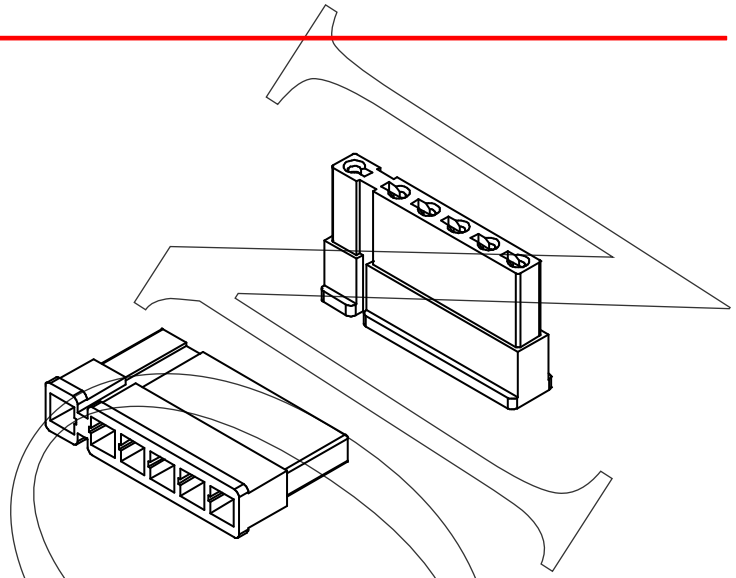

### Ordering Information and Dimensions:

Part No.	Circuits	Dim A	Dim B
156101HA001	1	--	--
156102HA001	2	--	--
156103HA001	3	5.0	17.5
156104HA001	4	10.0	22.5
156105HA001	5	15.0	27.5
156106HA001	6	20.0	32.5

## 1561 SERIES

### Housing

1. Part No.: 156102HB001
2. Part Name: 1561 Housing
3. Material: Nylon 66 UL 94V0
4. Color: Natural

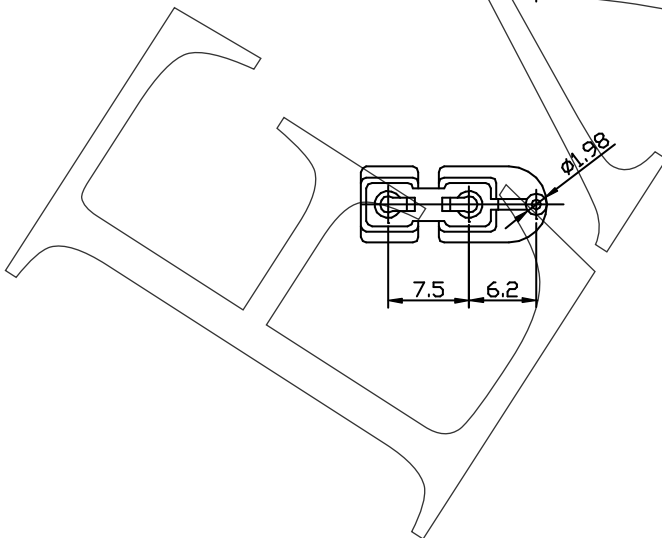
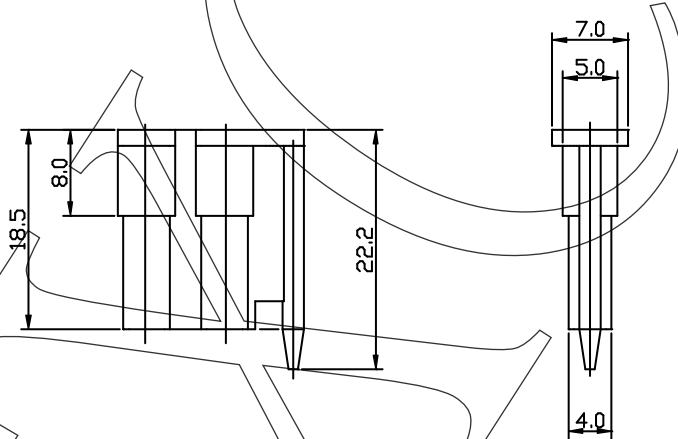
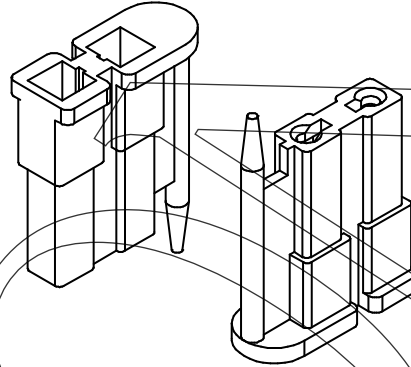

## 1561 SERIES

Wafer (Vertical type)

1. Part No.: 1561xxWV001
2. Part Name: 1561 Wafer
3. Material: Nylon 66 UL 94V0  
Pin: Brass bronze, Tin plated
5. Color: Natural

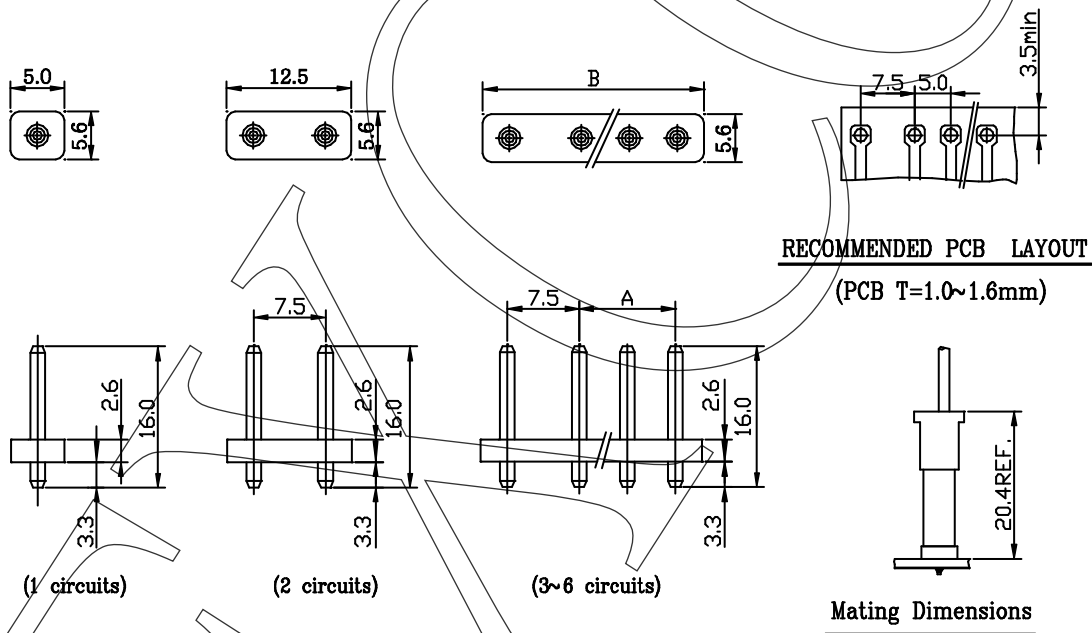
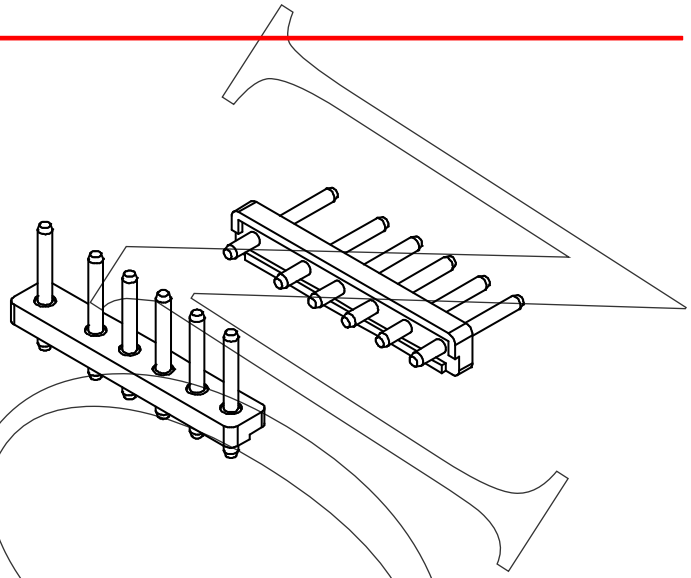

### Ordering Information and Dimensions:

Part No.	Circuits	Dim A	Dim B
156101WV001	1	--	5.0
156102WV001	2	--	12.5
156103WV001	3	5.0	17.5
156104WV001	4	10.0	22.5
156105WV001	5	15.0	27.5
156106WV001	6	20.0	33.0